

HauteWRAP[™] Outdoor Single Radio “All-In-One” Wireless Station

The HauteWRAP[™] family is specially designed for point-to-multipoint applications. It provides an easy solution for connecting many locations through wireless. The WRAPSTA model is the low cost, all-in-one station member of the family.

The HauteWRAP[™] provides high data rates and superior throughput for data-intensive, line-of-sight, or non-line-of-sight applications. It can function as an access point, a client bridge, mesh node, or WDS repeater. The WRAPSTA is a complete solution, combining housing, antenna, and router in one compact unit.

The HauteSpot “TDMA-like” protocol delivers unparalleled video streaming performance for the most demanding surveillance applications, and it can be used for 802.11.

HR-WRAPSTA



Applications

- Warehouse and inventory surveillance
- Transportation surveillance
- Public utility surveillance and control
- First responder mobile network
- Airport, rail yard, or port security
- Long range point-to-point links
- Campus surveillance
- Parking lot surveillance
- Low cost 802.11 Access Point

Functions

- Station Bridge or Station Router
- Extremely flexible, administrative management via web, Telnet, SSH, HS Configurator, and SNMP
- Sniffing, scanning, bandwidth utilization management
- Supports “behind the firewall” features that allows for easy video deployment
- Simple to use installer Web interface
- Multicast routing
- VLAN support
- QoS management
- Free management software
- Complete diagnostic tools

Features

- **All-in-One.** Weather resistant UV stabilized plastic outdoor enclosure with an integrated panel antenna.
- **Sustainability.** 6 Watts total operating power - can use solar power.
- **TDMA protocol.** The ideal solution for video streaming, where delay variation and jitter must be minimized.
- **Scalability.** Twice the scalability and performance of 802.11 protocols/mesh based devices.
- **Feature Rich.** HauteRouterOS software allows you to apply the most advanced firewall, NAT, bandwidth shaping, and other technologies to create a smart and manageable network.

Contact Us

Call toll-free: +1 (800) 541-5589

Inquiries: sales@hautespot.net

Web: www.hautespot.net

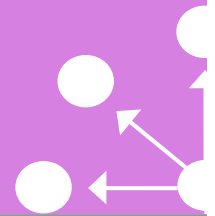

Specifications

HR-WRAPSTA

Radio Module Features

- **Data Rates**
 - OFDM :
 - BPSK. 6Mbps, 9 Mbps
 - QPSK. 12Mbps, 18Mbps
 - 16QAM. 24Mbps, 36Mbps
 - 64QAM. 48Mbps, 54Mbps
 - DSSS: 1, 2, 5.5, 11 Mbps.
- **Channel Width**
 - 5/10/20/40 MHz
- **Network Standards**
 - WECA (Wi-Fi & Wi-Fi5)
 - IEEE 802.11
 - IEEE 802.11a
 - IEEE 802.11g
 - IEEE 802.11b
 - IEEE 802.11e
 - IEEE 802.11f
 - IEEE 802.11h
 - IEEE 802.11i
- **Compliance**
 - FCC Part 15 Class B (modular)
 - ETSI 300.328
 - ETSI 300 826
 - CE mark
 - FCC Part 90Y (modular)
- **Frequency Options**
 - STATION 2-16: 2.4 GHz
 - STATION 37-18: 3.65 GHz
 - STATION 5-20: 5 GHz
 - STATION 9-10: 900 MHz
- **Physical & Environmental**
 - 6 Watts
 - 3.5 lbs
 - 11.12”(W) x 4.05” (L) x 10.49” (H)
 - 11-27 VDC input voltage
 - Wind load .77ft²
 - Pole mount 1.3 to 2 in diameter

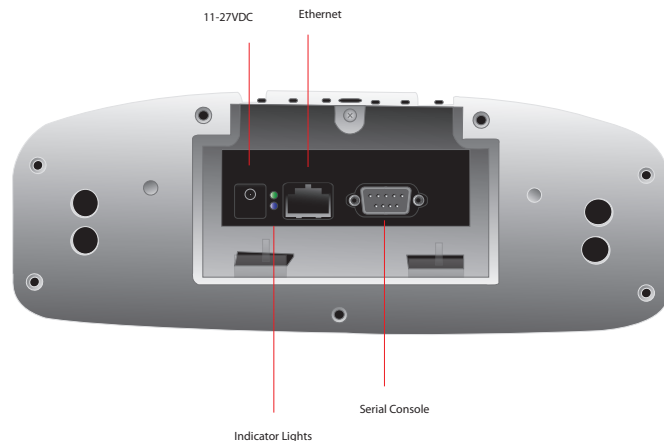

Router Features

- “TDMA-like” protocol for video performance
- MAC repeater settings for each client (enable/disable for each MAC address)
- MAC Firewall
- Client statistics (current signal level/quality, rate tx/rx, bytes tx/rx, radio rate)
- Authentication via remote RADIUS server using captive portal
- 40 and 128 bit WEP, WPA, and WPA2 support
- IP filtering
- Routing for RIP, BGP, OSPF, Mesh, and Multicast
- DNS relay
- DHCP server, relay, and client
- SNMP/SSH/Telnet/Java Client
- WDS (wireless distribution service) for transparent bridging

Hardware Features

- Mid performance embedded processor
- 10/100 Base-TX Ethernet port (with auto MDI/MDIX)
- Reverse voltage and transient protection
- -10°C to 70°C operating temperature
- 32Mbytes SDRAM
- Voltage and temperature monitor
- Watchdog timer
- Real Time Clock
- Integrated panel antenna
- Pole mount included
- Passive PoE injector and 90-240VAC power supply included
- Can free stand on window sill