

HauteSHOT[™] H.264 Video Encoding Wireless Bridge

The HauteSHOT[™] HR-IXPSXPi-264 is a complete, turn key solution for video streaming from virtually any analog input source to any playback destination.

Just attach any PAL or NTSC analog camera to the BNC input of the HauteSHOT[™] and it will digitally encode the video using the H.264 MPEG 4 codec. The video is multiplexed together with encoded audio and then streamed over a standard 802.11a wireless link anywhere within range.

Receive the signal on a standard 802.11a access point, such as the HauteWRAP HR-WRAPSXCi-5, and then decode the video on any Windows PC or with a hardware decoder.

HR-IXPSXPi-264



Applications

- Video surveillance
- Video over IP Streaming for real time broadcasting events
- IPTV broadcast
- Wireless IP Electronic News Gathering
- Broadcast production monitoring
- Police/Fire tactical surveillance
- Mobile Surveillance

Functions

- Perfectly synchronized video/ audio input
- Audio and audio out for two way audio multicast forwarding
- 1/16th to 30 Frames per second recording rate
- 4CIF, 2CIF, CIF or QCIF Resolution
- 1 Alarm input / 1 Relay output
- DVD-quality video (30fps@720x480-NTSC, 25fps 720x576-PAL) using MPEG4 Part 10 AVC H.264 standard encoding
- Wireless client bridge

Features

Compact. Small and lightweight black aluminum indoor enclosure.

Sustainability. 6 Watts total operating power - Can use solar power.

802.11a Protocol. The ideal solution for video streaming.

Scalability. Up to 6 cameras per AP

Feature Rich. A complete embedded highly reliable OS and wireless driver stack.

High Performance. Up to 45Mbps of actual TCP/IP throughput.

Simple Configuration. Browser management interface. Client software included.

Contact Us

Call toll-free: +1 (800) 541-5589

Inquiries: sales@hautespot.net

Web: www.hautespot.net

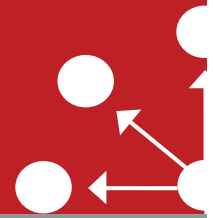

Specifications

HR- IXPSXPi-264

Radio Module Features

- **Data Rates**
 - OFDM :
 - BPSK. 6Mbps, 9 Mbps
 - QPSK. 12Mbps, 18Mbps
 - 16QAM. 24Mbps, 36Mbps
 - 64QAM. 48Mbps, 54Mbps
 - DSSS: 1, 2, 5.5, 11 Mbps.
- **Channel Width**
 - 20/40 MHz
- **Network Standards**
 - WECA (Wi-Fi & Wi-Fi5)
 - IEEE 802.11
 - IEEE 802.11a
 - IEEE 802.11e
 - IEEE 802.11f
 - IEEE 802.11h
 - IEEE 802.11i
- **Compliance**
 - FCC Part 15 Class B (modular)
 - ETSI 300.328
 - ETSI 300 826
 - CE mark
 - FCC Part 90Y(modular)
- **Frequency Options**
 - IXPSXPi-264-5: 5 GHz
- **Serial Interface**
 - RS 232 serial port
 - RS 485 support
 - Terminal emulation
 - Serial emulation
- **Physical & Environmental**
 - 6 Watts
 - 13.6 oz
 - 4" (W) x4" (L) x2.5" (H)
 - 9-20 VDC input voltage

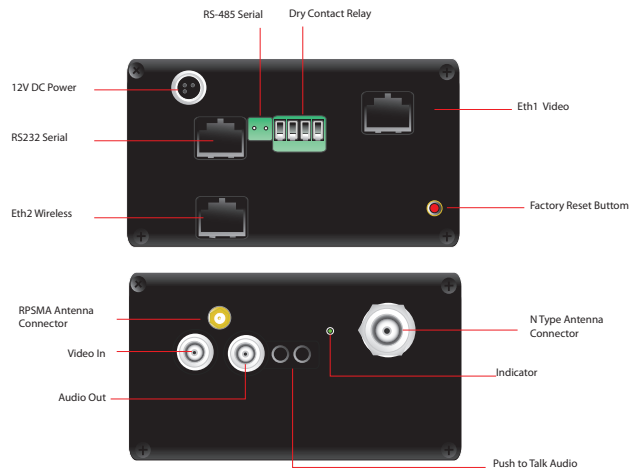

Bridge Features

- Authentication via remote RADIUS server using captive portal
- 40 and 128 bit WEP, WPA, and WPA2 support
- Full bi-directional 802.11a wireless bridge with integrated video encoder.
- DVD-quality video (30fps@720x480-NTSC, 25fps 720x576-PAL) using MPEG4 Part 10 AVC H.264 standard encoding
- Industry Leading Compression – H.264
- 4CIF, 2CIF, CIF or QCIF Resolution
- 1/16th to 30 Frames per second recording rate
- Perfectly synchronized video/ audio input
- Built-In Web server for remote video access and management via Internet Explorer

Hardware Features

- High Performance Intel® XScale® IXP Network Processor for near wire speed packet forwarding
- BNC connectors for video and audio input
- Mini plug ports for out of band push to talk two way audio
- RS-485 screw terminal connector
- RS-232 RJ45 connector
- RPSMA and N type antenna ports
- Positive locking connectors on all ports
- 10/100 Base-TX Ethernet port (with auto MDI/MDIX)
- -10°C to 70°C operating temperature
- Real Time Clock
- On-board flash
- 90-240VAC power supply included